

# Extension E-Ms

Item number 1033424801

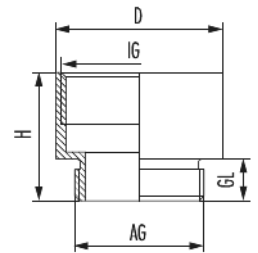

## Technical data

<b>Material</b>	Nickel-plated brass
<b>Tightening torque</b>	24 Nm
<b>Variant</b>	PG
<b>External thread (AG)</b>	PG 42
<b>Internal thread (IG)</b>	PG 48
<b>Thread length (GL)</b>	10 mm
<b>Height (H)</b>	33 mm
<b>D</b>	64 mm



# Extension E-Ms

Item number 1033424801

## Commercial data

Packaging Unit	10
EAN code	4033878400357
Weight	0.153 kg
ETIM 7	EC000938
ETIM 8	EC000938
ETIM 9	EC000938
eCl@ss 10.1	27-14-44-32
Customs tariff number	74122000

Note:

