

CABLE PROTECTION SYSTEMS

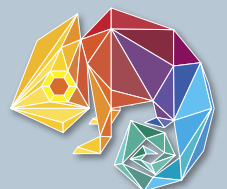

CONDUITS & FITTINGS



Reliable protection for cables

In industry, cables and wires are exposed to exceptional loads. Heat and cold, tensile and compressive loads, and wear-and-tear cause damage to cables and can result in malfunctions and loss of production. HUMMEL AG cable protection conduits provide reliable protection. Like a chameleon, the cable protection range is extremely versatile. The Polyamide range and the galvanised steel protective tubing of the metal range offer suitable solutions for every application. A wide range of fittings makes it easy for planners and designers to find the right answer for every requirement.

Polyamide

// **Polyamide-Conduit** – the flexible polyamide cable conduit

// **Polyamide-Fitting** – cable conduit for Polyamide-Conduit, made of galvanised steel

Metal

// **Metal-Conduit** – multi-layer variants for heavy loads

// **Metal-Fitting** – fittings for Metal-Conduits, designed for every type of installation

// **Metal-Conduit Pro** – ideal for metal protective conduits

// **Metal-Fitting Pro** – fittings for Metal-Conduit Pro, for exceptionally robust usage



Polyamide-Conduit ▶ 4

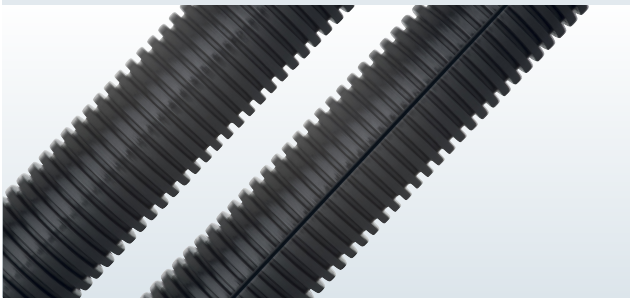

Polyamide cable conduits are characterised by their particularly high degree of flexibility. Whether in the standard or slit version, even extreme dynamic applications are no problem for Polyamide-Conduits. The large number of matching fittings and accessories provide solutions for all conceivable installation situations.

Polyamide-Fitting ▶ 6



A large selection of fittings and matching accessories round off the Polyamide-Conduit series into a well engineered concept. Thereby planners and installers are up to all assembly situations. With this professional protection improvised single solutions are things of the past.

Metal-Conduit / Metal-Fitting ▶ 16



The Metal range of protective cable conduits are particularly-resistant to mechanical stresses. The conduit types made of galvanized steel are able to withstand high pressure loads. Matching metal fittings complete the range, ensuring, that the system is 100 % industrial grade.

Metal-Conduit Pro / Metal-Fitting Pro ▶ 20

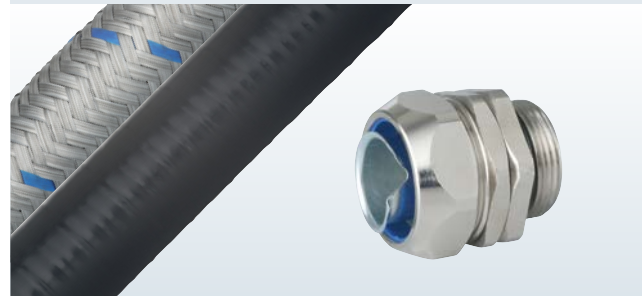

Metal-Conduit Pro offers a safe protection against heat and cold, intense mechanical loads and abrasion. The conduits are designed as multi-layer variants. They are available with PVC-Coating or exterior metal braiding. Fittings of the Metal-Fitting Pro series provide a perfect match for all Metal-Conduits of Serie Pro.

Accessories Polyamide ▶ 25



Accessories Metal ▶ 29



POLYAMIDE CABLE CONDUIT

Polyamide-Conduit



Material	Polyamide
Operating Temperature	-40 °C – +120 °C (-40 °F – +248 °F)
Colours	grey (RAL 7031), black (RAL 9005)

RoHS

// Raw material according to UL 94

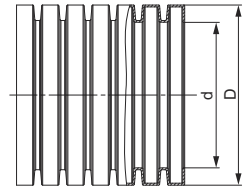

Size DN	d mm	D mm	R mm	Number grey	Number black
7	6,5	10	15	1.510.0600.14	1.510.0601.14
10	10	13	25	1.510.0900.14	1.510.0901.14
12	12	15,8	35	1.510.1100.14	1.510.1101.14
14	14,2	18,4	35	1.510.1300.14	1.510.1301.14
17	16,5	21,2	40	1.510.1600.14	1.510.1601.14
23	23	28,4	45	1.510.2100.14	1.510.2101.14
29	29	34,5	55	1.510.2900.14	1.510.2901.14
36	36	42,5	65	1.510.3600.14	1.510.3601.14
48	48	54,5	80	1.510.4800.14	1.510.4801.14

Polyamide-Conduit Slit



Material	Polyamide
Operating Temperature	-40 °C – +120 °C (-40 °F – +248 °F)
Colours	grey (RAL 7031), black (RAL 9005)

RoHS

// Raw material according to UL 94

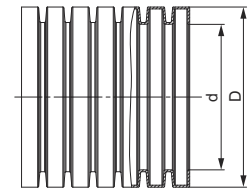

Size DN	d mm	D mm	 R mm	Number grey	Number black
7	6,5	10	15	1.527.0600.00	1.527.0601.00
10	10	13	25	1.527.0900.00	1.527.0901.00
12	12	15,8	35	1.527.1100.00	1.527.1101.00
14	14,2	18,4	35	1.527.1300.00	1.527.1301.00
17	16,5	21,2	40	1.527.1600.00	1.527.1601.00
23	23	28,4	45	1.527.2100.00	1.527.2101.00
29	29	34,5	55	1.527.2900.00	1.527.2901.00
36	36	42,5	65	1.527.3600.00	1.527.3601.00
48	48	54,5	80	1.527.4800.00	1.527.4801.00

Polyamide-Cut



Material Housing made of plastic / metal, antiskid rubber handle

Colour red

// Tool for easy, exact and safe cutting of Polyamide-Conduits

Cutting range	fits to DN	Number
0 – 26 mm	0 – 17	1.503.2600.00
0 – 63 mm	0 – 50	1.503.6300.00

Polyamide-Fitting



Material	Polyamide
Protection Category	IP 55
Operating Temperature	-30 °C – +80 °C (-22 °F – +176 °F)
Colours	grey (RAL 7031), black (RAL 9005)

RoHS

- // Raw material according to UL 94
- // Locknut optional
- // Easy disassembly without tools

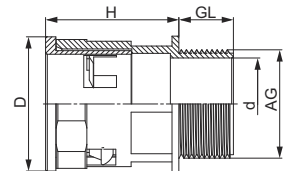

AG	d mm	D mm	GL mm	H mm	mm	fits to Polyamide-Conduit DN	Number grey	Number black
M 12	6,9	18,7	11	26	15	7	1.533.1200.50	1.533.1201.50
M 16	10,8	21,7	11	26	18	10	1.533.1600.51	1.533.1601.51
M 16	10,9	26	11	26,5	20	12	1.533.1600.50	1.533.1601.50
M 20	14,7	28	11	31	23	14	1.533.2000.51	1.533.2001.51
M 20	15,2	32	13	33	27	17	1.533.2000.50	1.533.2001.50
M 25	18,7	39,5	16	39	34	23	1.533.2500.50	1.533.2501.50
M 32	25,7	46,5	16	43	40	29	1.533.3200.50	1.533.3201.50
M 40	32,7	55,5	16	45,5	50	36	1.533.4000.50	1.533.4001.50
M 50	51,4	67,5	16	47,5	62	48	1.533.5000.50	1.533.5001.50
PG 7	6,9	18,7	11	26	15	7	1.533.0700.14	1.533.0701.14
PG 9	10,3	21,7	11	26	18	10	1.533.0900.14	1.533.0901.14
PG 11	13,3	26	11	26,5	20	12	1.533.1100.14	1.533.1101.14
PG 13,5	15,3	28	11	31	23	14	1.533.1300.14	1.533.1301.14
PG 16	16,6	32	13	33	27	17	1.533.1600.14	1.533.1601.14
PG 21	22,3	39,5	16	39	34	23	1.533.2100.14	1.533.2101.14
PG 29	31,7	46,5	16	43	40	29	1.533.2900.14	1.533.2901.14
PG 36	40,5	55,5	16	45,5	50	36	1.533.3600.14	1.533.3601.14
PG 48	51,7	67,5	16	47,5	62	48	1.533.4800.14	1.533.4801.14

Polyamide-Fitting 90



Material	Polyamide
Protection Category	IP 55
Operating Temperature	-30 °C – +80 °C (-22 °F – +176 °F)
Colours	grey (RAL 7031), black (RAL 9005)

RoHS

- // Raw material according to UL 94
- // Locknut optional
- // Easy disassembly without tools

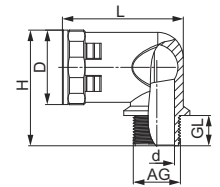

AG	d mm	D mm	GL mm	H mm	L mm	fits to Polyamide-Conduit DN	Number grey	Number black
M 12	8,2	18,7	11	36,3	35,7	7	1.535.1200.50	1.535.1201.50
M 16	10,8	21,7	11	37,3	38,5	10	1.535.1600.51	1.535.1601.51
M 16	10,9	26	11	41	43,8	12	1.535.1600.50	1.535.1601.50
M 20	14,7	28	11	44	46	14	1.535.2000.51	1.535.2001.51
M 20	15,2	32	13	51,5	51	17	1.535.2000.50	1.535.2001.50
M 25	18,7	39,5	16	61,2	64,3	23	1.535.2500.50	1.535.2501.50
PG 7	8,2	18,7	11	36,3	35,7	7	1.535.0700.14	1.535.0701.14
PG 9	10,3	21,7	11	37,3	38,5	10	1.535.0900.14	1.535.0901.14
PG 11	13,3	26	11	41	43,8	12	1.535.1100.14	1.535.1101.14
PG 13,5	15,3	28	11	44	46	14	1.535.1300.14	1.535.1301.14
PG 16	16,6	32	13	51,5	51	17	1.535.1600.14	1.535.1601.14
PG 21	22,4	39,5	16	61,2	64,3	23	1.535.2100.14	1.535.2101.14

Polyamide-Conduit

Polyamide-Fitting

Metal-Conduit / Metal-Fitting

Metal-Conduit Pro / Metal-Fitting Pro

Accessories Polyamide / Metal

Polyamide-Fitting T



Material	Polyamide
Protection Category	IP 67
Operating Temperature	-40 °C – +120 °C (-40 °F – +248 °F)
Colours	black

// Easy disassembly without tools

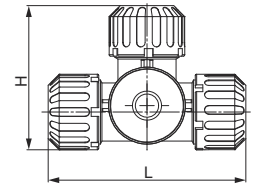

Size DN	L mm	H mm	fits to Polyamide-Conduit DN	Number black
DN10	50	68,5	10	1.536.0901.00
DN12	50,5	69,5	12	1.536.1101.00
DN17	58	80	17	1.536.1601.00
DN23	71	95	23	1.536.2101.00
DN29	84	109	29	1.536.2901.00

Polyamide-Fitting Y



Material	Polyamide
Protection Category	IP 55
Operating Temperature	-40 °C – +120 °C (-40 °F – +248 °F)
Colours	black

// Easy disassembly without tools

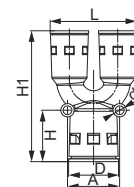

Size DN	d mm	D mm	A mm	H mm	H1 mm	L mm	fits to Polyamide-Conduit DN	Number black
DN12/10/10	5,5	22,3	25	31	74	42	12/10/10	1.537.1101.00
DN17/12/12	6,5	28	32	32	85	51	17/12/12	1.537.1601.00
DN23/17/17	6,5	36,4	38	38	90,5	63,8	23/17/17	1.537.2101.00
DN29/23/23	6,5	43	45	37	106	76,8	29/23/23	1.537.2901.00



Material	Polyamide
Protection Category	IP 54 with O-Ring with fixed conduit mounting IP 65
Operating Temperature	-20 °C – +80 °C (-4 °F – +176 °F)
Colours	grey (RAL 7031), black (RAL 9005)



// Protection against unintended disconnect. Use screwdriver to disassemble

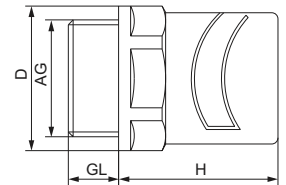

AG	D mm	GL mm	H mm	 mm	fits to Polyamide-Conduit DN	Number grey	Number black
M 16 x 1,5	20	8	23	17	10	1.511.1600.50	1.511.1601.50
M 20 x 1,5	26,5	9	28	24	14	1.511.2000.50	1.511.2001.50
M 25 x 1,5	38,5	11	32	35	23	1.511.2500.50	1.511.2501.50
M 32 x 1,5	46	11	35	42	29	1.511.3200.50	1.511.3201.50
PG 9	19	8	23	17	10	1.511.0900.14	1.511.0901.14
PG 11	23	8	25	21	12	1.511.1100.14	1.511.1101.14
PG 13,5	26,5	9	28	24	14	1.511.1300.14	1.511.1301.14
PG 16	30	10	29	27	17	1.511.1600.14	1.511.1601.14
PG 21	38,5	11	32	35	23	1.511.2100.14	1.511.2101.14
PG 29	46	11	35	42	29	1.511.2900.14	1.511.2901.14
PG 36	54,5	13	41	50	36	1.511.3600.14	1.511.3601.14
NPT 3/8"	19	15	23	17	10	1.511.3800.70	1.511.3801.70
NPT 1/2"	30	13	29	27	17	1.511.1216.70	1.511.1217.70
NPT 3/4"	38,5	13	32	35	23	1.511.3400.70	1.511.3401.70
NPT 1"	46	15	35	42	29	1.511.1000.70	1.511.1001.70

Polyamide-Fitting W

Metr., PG, NPT



Material	Polyamide
O-Ring	NBR
Protection Category	IP 54 with fixed conduit mounting IP 65
Operating Temperature	-20 °C – +80 °C (-4 °F – +176 °F)
Colours	black (RAL 9005)



// Protection against unintended disconnect. Use screwdriver to disassemble

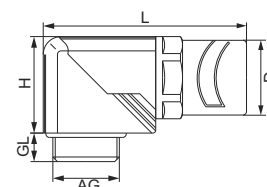

AG	D mm	GL mm	H mm	L mm	mm	fits to Polyamide-Conduit DN	Number
M 16 x 1,5	20	8	23	43	19	10	1.513.1601.50
M 20 x 1,5	26,5	9	30,5	52	24	14	1.513.2001.50
M 25 x 1,5	38,5	11	40	70	33	23	1.513.2501.50
M 32 x 1,5	46	11	51,5	83	42	29	1.513.3201.50
PG 9	19	8	23	43	19	10	1.513.0901.14
PG 11	23	8	27	48	22	12	1.513.1101.14
PG 13,5	26,5	9	30,5	52	24	14	1.513.1301.14
PG 16	30	10	32,5	56	27	17	1.513.1601.14
PG 21	38,5	11	40	70	33	23	1.513.2101.14
PG 29	46	11	51,5	83	42	29	1.513.2901.14
NPT 3/8"	19	15	23	43	19	10	1.513.3801.70
NPT 1/2"	30	13	32,5	56	27	17	1.513.1217.70
NPT 3/4"	38,5	13	40	70	33	23	1.513.3401.70
NPT 1"	46	15	51,5	83	42	29	1.513.1001.70



Material	Nickel plated brass
Clamping Insert	Polyamide
Seal	NBR
Protection Category	IP 68 – 10 bar / IP 69K (NEMA 6 – 150 PSIG) on the cable gland
Operating Temperature	-40 °C – +100 °C (-40 °F – +212 °F)

- // 2 in 1 cable gland and conduit fitting
- // Easy disassembly without tools

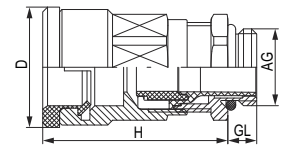

AG	∅ _k mm	GL mm	H mm	D mm	∅ _h mm	fits to Polyamide- Conduit DN	Number
M 16	05–10	6	36	23	20/20	10	1.547.1610.50
M 16	03–07	6	36	23	20/20	10	1.547.1610.51
M 20	10–14	6	39,5	25	24/22	12	1.547.2012.50
M 20	07–12	6	39,5	25	24/22	12	1.547.2012.51
M 20	10–14	6	40,5	29	28/24	14	1.547.2014.50
M 20	07–12	6	40,5	29	28/24	14	1.547.2014.51
M 25	13–18	7	44.5	30	30/30	17	1.547.2517.50
M 25	09–16	7	44.5	30	30/30	17	1.547.2517.51
M 32	18–24	8	50,5	39	40/40	23	1.547.3223.50
M 32	13–20	8	50,5	39	40/40	23	1.547.3223.51
M 40	22–31	8	56,5	45	50/50	29	1.547.4029.50
M 40	20–26	8	56,5	45	50/50	29	1.547.4029.51
M 50	32–36	9	57,5	52	57/57	36	1.547.5037.50
M 50	25–31	9	57,5	52	57/57	36	1.547.5037.51
M 63	37–44	10	60,5	52	68/64	48	1.547.6350.50
M 63	29–35	10	60,5	52	68/64	48	1.547.6350.51
PG 11	05–10	6	36	23	20/20	10	1.548.1110.01
PG 11	03–07	6	36	23	20/20	10	1.548.1110.15
PG 13,5	6–12	6,5	39,5	25	24/22	12	1.548.1312.01
PG 13,5	5–9	6,5	39,5	25	24/22	12	1.548.1312.15
PG 16	10–14	6,5	40,5	29	28/24	14	1.548.1614.01
PG 16	07–12	6,5	40,5	29	28/24	14	1.548.1614.15
PG 21	13–16	7	44.5	30	30/30	17	1.548.2117.01
PG 21	09–16	7	44.5	30	30/30	17	1.548.2117.15
PG 29	18–22	8	50,5	39	40/40	23	1.548.2923.01
PG 29	13–20	8	50,5	39	40/40	23	1.548.2923.15
PG 36	22–28	8	56,5	45	50/50	29	1.548.3629.01
PG 36	20–26	8	56,5	45	50/50	29	1.548.3629.15
PG 42	32–36	9	57,5	52	57/57	36	1.548.4237.01
PG 42	25–31	9	57,5	52	57/57	36	1.548.4237.15
PG 48	37–44	10	60,5	52	64/64	48	1.548.4850.01
PG 48	29–35	10	60,5	52	64/64	48	1.548.4850.15

Polyamide-Fitting DUO-Ms

NPT



Material	Nickel plated brass
Clamping Insert	Polyamide
Seal	NBR
Protection Category	IP 68 – 10 bar / IP 69K (NEMA 6 – 150 PSIG) on the cable gland
Operating Temperature	-40 °C – +100 °C (-40 °F – +212 °F)



- // 2 in 1 cable gland and conduit fitting
- // Easy disassembly without tools

AG	∅ mm	GL mm	H mm	D mm	∅ mm	fits to Polyamide-Conduit DN	Number
NPT 1/2"	10–14	13	40,5	29	28/24	14	1.547.1214.70
NPT 1/2"	07–12	13	40,5	29	28/22	14	1.547.1214.71
NPT 3/4"	13–18	13	44,5	30	30/30	17	1.547.3417.70
NPT 3/4"	09–16	13	44,5	30	30/30	17	1.547.3417.71
NPT 1"	18–24	19	50,5	39	40/40	23	1.547.1023.70
NPT 1"	13–20	19	50,5	39	40/40	23	1.547.1023.71

Polyamide-Conduit

Polyamide-Fitting

Metal-Conduit / Metal-Fitting

Metal-Conduit Pro / Metal-Fitting Pro

Accessories Polyamide / Metal



Material	Polyamide
Seal	NBR
Protection Category	IP 68 – 10 bar / IP 69K (NEMA 6 – 150 PSIG) on the cable gland
Operating Temperature	-40 °C – +100 °C (-40 °F – +212 °F)
Colours	black (RAL 9005)

// 2 in 1 cable gland and conduit fitting
 // Easy disassembly without tools

AG	∅ _k mm	GL mm	H mm	D mm	∅ _h mm	fits to Polyamide- Conduit DN	Number
M 16	05–10	8	40	23	22	10	1.542.1610.50
M 16	03–07	8	40	23	22	10	1.542.1610.51
M 20	06–12	10	44	25	24	12	1.542.2012.50
M 20	05–09	10	44	25	24	12	1.542.2012.51
M 20	10–14	10	46	29	27	14	1.542.2014.50
M 20	07–12	10	46	29	27	14	1.542.2014.51
M 25	13–18	11	50	30	33	17	1.542.2517.50
M 25	09–16	11	50	30	33	17	1.542.2517.51
M 32	18–24	11	60	39	42	23	1.542.3223.50
M 32	13–20	11	60	39	42	23	1.542.3223.51
M 40	22–31	13	69	45	53	29	1.542.4029.50
M 40	20–26	13	69	45	53	29	1.542.4029.51
M 50	32–36	13	74	52	60	36	1.542.5037.50
M 50	25–31	13	74	52	60	36	1.542.5037.51
M 63	37–44	14	79	52	68	48	1.542.6350.50
M 63	29–35	14	79	52	68	48	1.542.6350.51
PG 11	05–10	8	40	23	22	10	1.543.1110.14
PG 11	03–07	8	40	23	22	10	1.543.1110.15
PG 13,5	06–12	9	44	25	24	12	1.543.1312.14
PG 13,5	05–09	9	44	25	24	12	1.543.1312.15
PG 16	10–14	10	47	29	27	14	1.543.1614.14
PG 16	07–12	10	47	29	27	14	1.543.1614.15
PG 21	13–16	11	50	30	33	17	1.543.2117.14
PG 21	09–16	11	50	30	33	17	1.543.2117.15
PG 29	18–22	11	60	39	42	23	1.543.2923.14
PG 29	13–20	11	60	39	42	23	1.543.2923.15
PG 36	22–31	13	69	45	53	29	1.543.3629.14
PG 36	20–26	13	69	45	53	29	1.543.3629.15
PG 42	32–36	13	74	52	60	36	1.543.4237.14
PG 42	25–31	13	74	52	60	36	1.543.4237.15
PG 48	37–44	14	79	52	68	48	1.543.6350.14
PG 48	29–35	14	79	52	68	48	1.543.6350.15

Polyamide-Fitting DUO-PA

NPT



Material	Polyamide
Seal	NBR
Protection Category	IP 68 – 10 bar / IP 69K (NEMA 6 – 150 PSIG) on the cable gland
Operating Temperature	-40 °C – +100 °C (-40 °F – +212 °F)
Colours	black (RAL 9005)



- // 2 in 1 cable gland and conduit fitting
- // Easy disassembly without tools

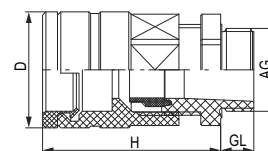

AG	∅ mm	GL mm	H mm	D mm	mm	fits to Polyamide-Conduit DN	Number
NPT 1/2"	10–14	13	46	29	27	14	1.542.1214.70
NPT 1/2"	07–12	13	46	29	27	14	1.542.1214.71
NPT 3/4"	13–18	14	50	30	33	17	1.542.3417.70
NPT 3/4"	09–16	14	50	30	33	17	1.542.3417.71
NPT 1"	18–24	19	60	39	42	23	1.542.1023.70
NPT 1"	13–20	19	60	39	42	23	1.542.1023.71
NPT 1 1/2"	22–31	20	69	45	53	29	1.542.6429.70

Polyamide-Conduit

Polyamide-Fitting

Metal-Conduit / Metal-Fitting

Metal-Conduit Pro / Metal-Fitting Pro

Accessories Polyamide / Metal

METAL CABLE CONDUIT

Metal-Conduit A



Material	galvanised steel
Protection Category	IP 40
Operating Temperature	-100 °C – +300 °C (-148 °F – +572 °F)

RoHS

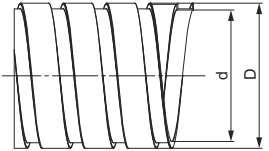

Size DN	d mm	D mm	R mm	Number
7	7,5	10,5	25	1.560.0760.00
9	9	12	30	1.560.0960.00
11	11	14	30	1.560.1160.00
14	14	17	40	1.560.1460.00
16	16	19	45	1.560.1660.00
21	21	24	55	1.560.2160.00
26	26	30	55	1.560.2660.00
37	37	41	80	1.560.3760.00
40	40	44	80	1.560.4060.00
51	51	55	90	1.560.5160.00

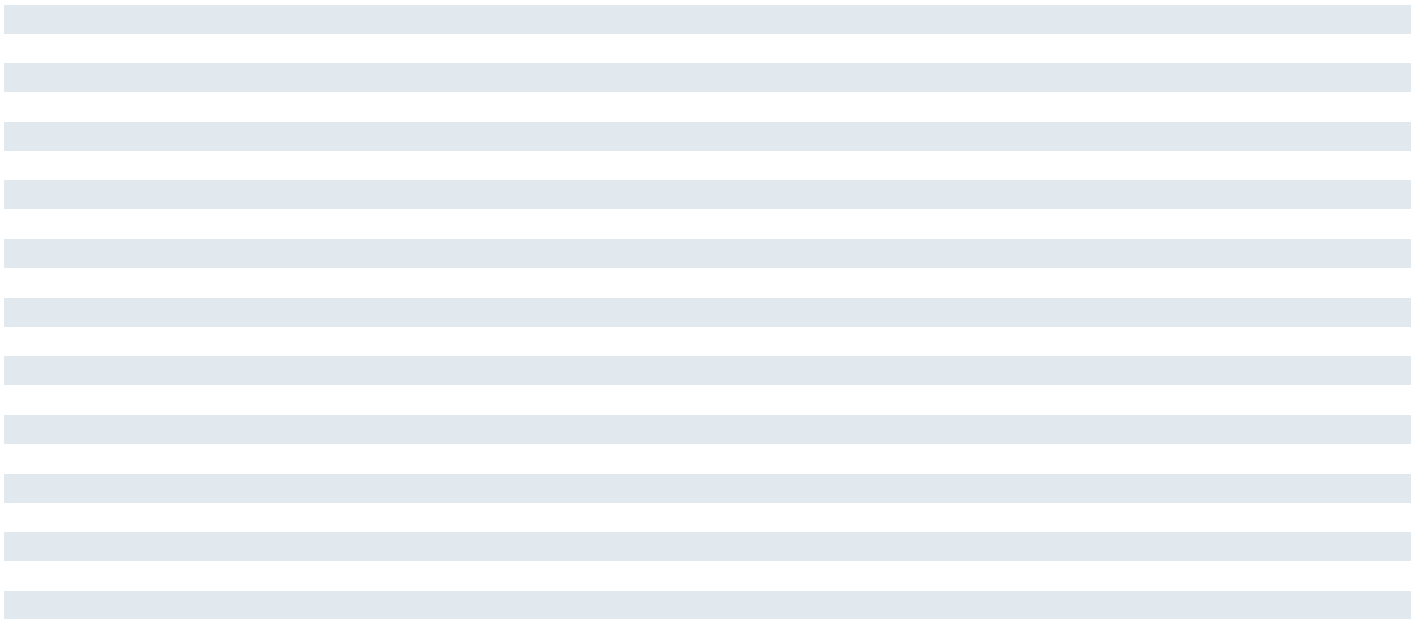

Metal-Conduit B



Material	galvanised steel, PVC coating
Protection Category	IP 65
Operating Temperature	-15 °C – +70 °C (+5 °F – +158 °F)

RoHS

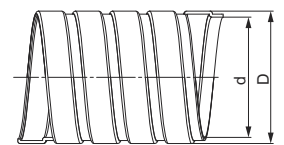

Size DN	d mm	D mm	R mm	Number
7	7,5	11,5	25	1.561.0761.00
9	9	13	30	1.561.0961.00
11	11	15	30	1.561.1161.00
14	14	18	40	1.561.1461.00
16	16	20	45	1.561.1661.00
21	21	25	55	1.561.2161.00
26	26	31	55	1.561.2661.00
37	37	42	80	1.561.3761.00
40	40	45	80	1.561.4061.00
51	51	56	90	1.561.5161.00

Polyamide-Conduit

Polyamide-Fitting

Metal-Conduit / Metal-Fitting

Metal-Conduit Pro / Metal-Fitting Pro

Accessories Polyamide / Metal

Metal-Fitting



Material	Nickel plated brass
Protection Category	IP 54
Operating Temperature	-20 °C – +80 °C (-4 °F – +176 °F)

RoHS

- // Fixed mounted conduit fitting
- // Locknut optional

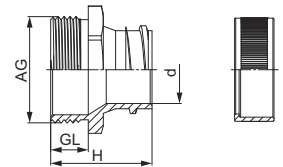

AG	d mm	GL mm	H mm	mm	fits to Metal-Conduit DN	Number
M 12	6	8	24	15	7	1.570.1260.50
M 16	7	8	24	20	9	1.570.1660.51
M 16	9	10	26	20	11	1.570.1660.50
M 20	12	10	26	22	14	1.570.2060.51
M 20	14	10	26	22	16	1.570.2060.50
M 25	18	10	27	28	21	1.570.2560.50
M 32	23	12	31	35	26	1.570.3260.50
M 40	33,5	14	36	45	37	1.570.4060.50
M 50	37	14	36	55	40	1.570.5060.50
M 63	46	14	36	65	51	1.570.6360.50
PG 7	6	8	24	15	7	1.570.0760.14
PG 9	7	8	24	17	9	1.570.0960.14
PG 11	9	10	26	20	11	1.570.1160.14
PG 13,5	12	10	26	22	14	1.570.1360.14
PG 16	14	10	26	24	16	1.570.1660.14
PG 21	18	10	27	30	21	1.570.2160.14
PG 29	23	12	31	40	26	1.570.2960.14
PG 36	33,5	14	36	50	37	1.570.3660.14
PG 42	37	14	36	60	40	1.570.4260.14
PG 48	46	14	36	65	51	1.570.4860.14
NPT 1/4"	6	10	26	15	7	1.570.1460.70
NPT 3/8"	7	11,5	27,5	20	9	1.570.3860.71
NPT 3/8"	9	11,5	27,5	20	11	1.570.3860.70
NPT 1/2"	12	13	29	22	14	1.570.1260.71
NPT 1/2"	14	13	29	22	16	1.570.1260.70
NPT 3/4"	18	15	32	28	21	1.570.3460.70
NPT 1"	23	15	34	35	26	1.570.1060.70
NPT 1 1/4"	33,5	16	38	45	37	1.570.5460.70
NPT 1 1/2"	37	18	40	55	40	1.570.6460.70
NPT 2"	46	20	42	65	51	1.570.2060.70

Metal-Fitting S



Material	Nickel plated brass
Protection Category	IP 54
Operating Temperature	-20 °C – +80 °C (-4 °F – +176 °F)

RoHS

- // Swivel conduit fitting
- // Locknut optional

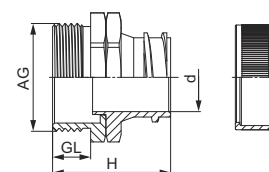

AG	d mm	GL mm	H mm	 mm	fits to Metal- Conduit DN	Number
M 12	6	8	27	15	7	1.571.1260.50
M 16	7	8	27	20	9	1.571.1660.51
M 16	9	10	29	20	11	1.571.1660.50
M 20	12	10	29	22	14	1.571.2060.51
M 20	14	10	29	22	16	1.571.2060.50
M 25	18	10	31	28	21	1.571.2560.50
M 32	23	12	35	35	26	1.571.3260.50
M 40	33,5	14	41	45	37	1.571.4060.50
M 50	37	14	41	55	40	1.571.5060.50
M 63	46	14	41	65	51	1.571.6360.50
PG 7	6	8	27	15	7	1.571.0760.14
PG 9	7	8	27	17	9	1.571.0960.14
PG 11	9	10	29	20	11	1.571.1160.14
PG 13,5	12	10	29	22	14	1.571.1360.14
PG 16	14	10	29	24	16	1.571.1660.14
PG 21	18	10	31	30	21	1.571.2160.14
PG 29	23	12	35	40	26	1.571.2960.14
PG 36	33,5	14	41	50	37	1.571.3660.14
PG 42	37	14	41	60	40	1.571.4260.14
PG 48	46	14	41	65	51	1.571.4860.14
NPT 1/4"	6	10	29	15	7	1.571.1460.70
NPT 3/8"	7	11,5	30,5	20	9	1.571.3860.71
NPT 3/8"	9	11,5	30,5	20	11	1.571.3860.70
NPT 1/2"	12	13	32	22	14	1.571.1260.71
NPT 1/2"	14	13	32	22	16	1.571.1260.70
NPT 3/4"	18	15	36	28	21	1.571.3460.70
NPT 1"	23	15	39	35	26	1.571.1060.70
NPT 1 1/4"	33,5	16	43	45	37	1.571.5460.70
NPT 1 1/2"	37	18	45	55	40	1.571.6460.70
NPT 2"	46	20	47	65	51	1.571.2060.70



METAL CABLE CONDUIT

Metal-Conduit Pro A



Material	galvanised steel, PVC coating
Protection Category	IP 66
Operating Temperature	-20 °C – +105 °C (-4 °F – +221 °F)

RoHS

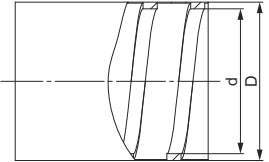

Size DN	d mm	D mm	 R (mm)	Number
10	10,3	16	40	1.562.1061.00
12	12,3	18	45	1.562.1261.00
16	15,5	21	65	1.562.1661.00
21	20,9	26,5	100	1.562.2161.00
27	26,5	33,3	135	1.562.2761.00
35	35	42	175	1.562.3561.00
40	40	48,2	230	1.562.4061.00
51	51,5	60	280	1.562.5161.00

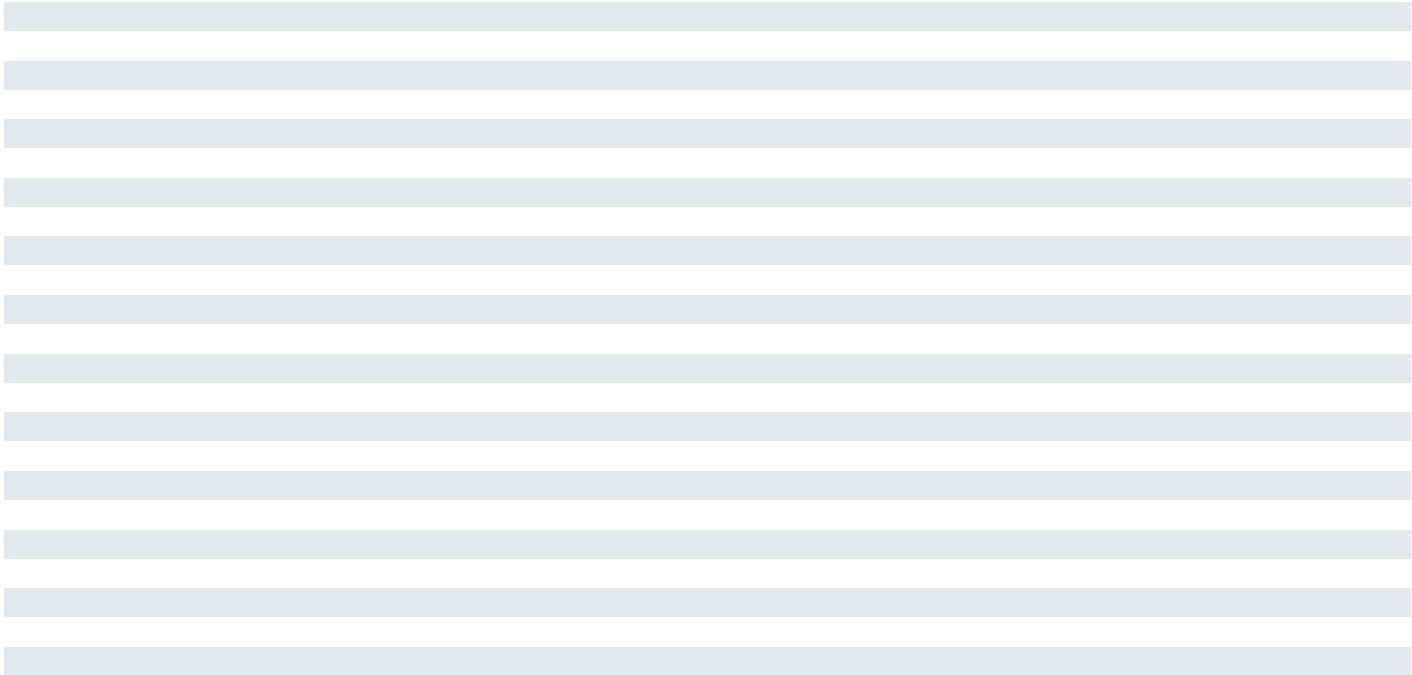

Metal-Conduit Pro B



Material	galvanised steel
Protection Category	IP 40
Operating Temperature	-100 °C – +300 °C (-148 °F – +572 °F)

RoHS

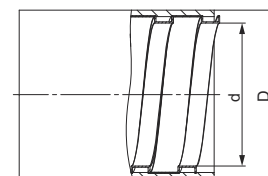

Size DN	d mm	D mm	R mm	Number
9	9	14	30	1.563.0960.00
11	11	16	35	1.563.1160.00
13	13	17,5	40	1.563.1360.00
16	16	21	45	1.563.1660.00
21	21	26	55	1.563.2160.00
26	26	32	70	1.563.2660.00
35	35	41	80	1.563.3560.00
40	40	46	90	1.563.4060.00
51	51	57	90	1.563.5160.00

Polyamide-Conduit

Polyamide-Fitting

Metal-Conduit / Metal-Fitting

Metal-Conduit Pro / Metal-Fitting Pro

Accessories Polyamide / Metal

METAL CABLE CONDUIT

Metal-Conduit Pro C



Material	galvanised steel
Protection Category	IP 65
Operating Temperature	-15 °C – +70 °C (+5 °F – +158 °F)

RoHS

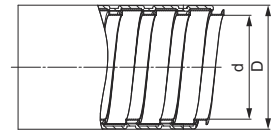

Size DN	d mm	D mm	$\frac{R}{mm}$	Number
9	9	15	30	1.564.0960.00
11	11	17	35	1.564.1160.00
13	13	18,5	40	1.564.1360.00
16	16	22	45	1.564.1660.00
21	21	27	55	1.564.2160.00
26	26	33	70	1.564.2660.00
35	35	42	80	1.564.3560.00
40	40	47	90	1.564.4060.00
51	51	58	90	1.564.5160.00

Metal-Fitting Pro



Material	Nickel plated brass
Protection Category	IP 67
Operating Temperature	-20 °C – +80 °C (-4 °F – +176 °F)

RoHS

- // Fixed mounted conduit fitting
- // Locknut optional

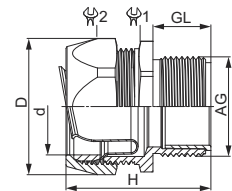

AG	d mm	D mm	GL mm	H mm	1 mm	2 mm	fits to Metal- Conduit Pro DN	Number
M 12	16,5	24,5	10	31	20	22	-/09	1.572.1260.50
M 16	19	29,2	10	35	24	26	11/12	1.572.1660.51
M 16	22	32,6	11,5	39	27	29	12/13	1.572.1660.50
M 20	22	32,6	13	38,7	27	29	16	1.572.2060.50
M 25	27,5	38,8	15	41	33	35	21	1.572.2560.50
M 32	34,5	50	15	49	43	45	26/27	1.572.3260.50
M 40	43,5	60	16	51	52	54	35	1.572.4060.50
M 50	49,5	69,3	18	61	60	63	40	1.572.5060.50
M 63	62	85	20	73	74	77	51	1.572.6360.50
PG 7	16,5	24,5	10	31	20	22	-/09	1.572.0760.14
PG 9	16,5	24,5	10	31	20	22	11/12	1.572.0960.14
PG 11	19	29,2	11,5	35	24	26	12/13	1.572.1160.14
PG 13,5	22	32,6	13	39	27	29	16	1.572.1360.14
PG 16	22	32,6	13	38,7	27	29	16	1.572.1660.14
PG 21	27,5	38,8	15	41	33	35	21	1.572.2160.14
PG 29	34,5	50	15	49	43	45	26/27	1.572.2960.14
PG 36	43,5	60	16	51	52	54	35	1.572.3660.14
PG 42	49,5	69,3	18	61	60	63	40	1.572.4260.14
PG 48	62	85	20	73	74	77	51	1.572.4860.14
NPT 1/4"	16,5	24,5	10	31	20	22	10/11	1.572.1460.70
NPT 3/8"	19	29,2	11,5	35	20	22	12/13	1.572.3860.70
NPT 1/2"	22	32,6	13	38,7	27	29	16	1.572.1260.70
NPT 3/4"	27,5	38,8	15	41	33	35	21	1.572.3460.70
NPT 1"	34,5	50	15	49	43	45	27/26	1.572.1060.70
NPT 1 1/4"	43,5	60	16	51	52	54	35	1.572.5460.70
NPT 1 1/2"	49,5	69,3	18	61	60	63	40	1.572.6460.70
NPT 2"	62	85	20	73	74	77	51	1.572.2060.70

Metal-Fitting Pro S



Material	Nickel plated brass
Protection Category	IP 67
Operating Temperature	-20 °C – +80 °C (-4 °F – +176 °F)

RoHS

- // Swivel conduit fitting
- // Locknut optional

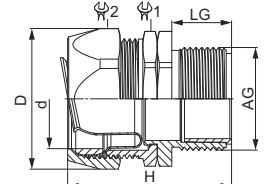

AG	d mm	D mm	GL mm	H mm	1 mm	2 mm	fits to Metal- Conduit Pro DN	Number
M 12	16,5	24,5	10	34	20	22	-/09	1.573.1260.50
M 16	16,5	24,5	10	35	20	22	10/11	1.573.1660.51
M 16	19	29,2	10	37	20	22	12/13	1.573.1660.50
M 20	22	32,6	13	41	27	29	16	1.573.2060.50
M 25	27,5	38,8	15	44	33	35	21	1.573.2560.50
M 32	34,5	50	15	51	43	45	27/26	1.573.3260.50
M 40	43,5	60	16	54	52	54	35	1.573.4060.50
M 50	49,5	69,3	18	64	60	63	40	1.573.5060.50
M 63	62	85	20	76	74	77	51	1.573.6360.50
PG 7	16,5	24,5	10	34	20	22	-/09	1.573.0760.14
PG 9	16,5	24,5	10	34	20	22	10/11	1.573.0960.14
PG 11	19	29,2	11,5	35	24	26	12/13	1.573.1160.14
PG 13,5	22	32,6	13	37	27	29	16	1.573.1360.14
PG 16	22	32,6	13	41	27	29	16	1.573.1660.14
PG 21	27,5	38,8	15	44	33	35	21	1.573.2160.14
PG 29	34,5	50	15	51	43	45	27/26	1.573.2960.14
PG 36	43,5	60	16	54	52	54	35	1.573.3660.14
PG 42	49,5	69,3	18	64	60	63	40	1.573.4260.14
PG 48	62	85	20	76	74	77	51	1.573.4860.14
NPT 1/4"	16,5	24,5	10	35	20	22	10/11	1.573.1460.70
NPT 3/8"	19	29,2	11,5	37	20	22	12/13	1.573.3860.70
NPT 1/2"	22	32,6	13	41	27	29	16	1.573.1260.70
NPT 3/4"	27,5	38,8	15	44	33	35	21	1.573.3460.70
NPT 1"	34,5	50	15	51	43	45	26/27	1.573.1060.70
NPT 1 1/4"	43,5	60	16	54	52	54	35	1.573.5460.70
NPT 1 1/2"	49,5	69,3	18	64	60	63	40	1.573.6460.70
NPT 2"	62	85	20	76	74	77	51	1.573.2060.70

Polyamide-Fitting Clip



Material	Polyamide
Operating Temperature	-30 °C – +80 °C (-22 °F – +176 °F)
Colours	black (RAL 9005)

RoHS

// Raw material according to UL 94

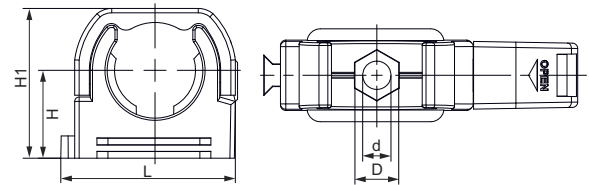

Size DN	d mm	D mm	L mm	H mm	H1 mm	fits to Polyamide-Conduit DN	Number black
DN10	5	7	28,7	15,75	27,5	10	1.534.0901.00
DN12	5,3	8,3	29,8	13,1	24	12	1.534.1101.00
DN14	5,3	8,5	35,2	17,75	29,3	14	1.534.1401.00
DN17	5,3	8,5	40,2	19,75	33,2	17	1.534.1601.00
DN23	5,3	8,7	52,6	23,5	40,5	23	1.534.2101.00
DN29	6,5	11	60,7	27	48	29	1.534.2901.00
DN37	6,5	11	69	30,4	57	36	1.534.3601.00
DN50	6,5	11	87	37,9	71	48	1.534.4801.00

Polyamide-Conduit

Polyamide-Fitting

Metal-Conduit / Metal-Fitting

Metal-Conduit Pro / Metal-Fitting Pro

Accessories Polyamide / Metal



Material	Polyamide (Type A / Type B), Polypropylene (Type C)
Operating Temperature	-20 °C – +80 °C (-4 °F – +176 °F)
Colours	black (RAL 9005)

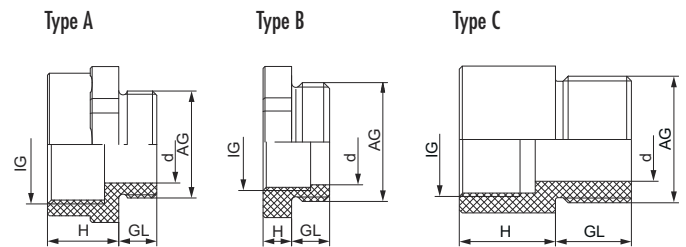

AG	IG mm	Type	d mm	GL mm	H mm	mm	Number
M 16 x 1,5	M 12 x 1,5	B	10	8	6	20	1.273.1612.50
M 20 x 1,5	M 16 x 1,5	B	13,5	8	6	25	1.273.2016.50
M 25 x 1,5	M 20 x 1,5	B	18	8	6	29	1.273.2520.50
M 32 x 1,5	M 25 x 1,5	B	23	10	6	36	1.273.3225.50
M 40 x 1,5	M 32 x 1,5	C	30	15	5		1.273.4032.50
M 50 x 1,5	M 40 x 1,5	C	38	15	5		1.273.5040.50
M 63 x 1,5	M 50 x 1,5	C	48	15	5		1.273.6350.50
M 25 x 1,5	PG 13,5	B	18	8	6	29	1.273.2513.50
M 25 x 1,5	PG 16	A	18	8	14	29	1.273.2516.50
M 32 x 1,5	PG 21	A	25	10	15	36	1.273.3221.50
M 40 x 1,5	PG 29	A	33	10	15	45	1.273.4029.50
M 50 x 1,5	PG 36	A	43	12	17	55	1.273.5036.50
M 63 x 1,5	PG 42	C	52	15	5		1.273.6342.50
PG 9	M 12 x 1,5	C	15	19	8,5		1.273.0912.11
PG 11	M 16 x 1,5	C	15	19	11,5		1.273.1116.11
PG 13,5	M 16 x 1,5	B	25	8	6	14	1.273.1316.11
PG 16	M 20 x 1,5	A	27	8	13	16	1.273.1620.11
PG 21	M 25 x 1,5	C	15	19	20,5		1.273.2125.11
PG 29	M 32 x 1,5	C	15	19	28		1.273.2932.11
PG 36	M 40 x 1,5	C	15	5	38		1.273.3640.11
PG 42	M 40 x 1,5	C	15	5	38		1.273.4240.11
PG 48	M 50 x 1,5	C	15	5	38		1.273.4850.11

Adapter E-M-PA, K-FS

Metr., PG



Material	Polyamide (Type A / Type B), Polypropylene (Type C)
Operating Temperature	-20 °C – +80 °C (-4 °F – +176 °F)
Colours	K-FS grey (RAL 7035), E-M-PA black (RAL 9005)

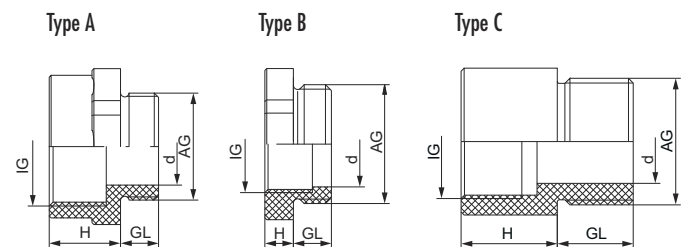

AG	IG mm	Type	d mm	GL mm	H mm	mm	Number
M 12 x 1,5	M 16 x 1,5	A	6,5	8	12	21	1.239.1216.50
M 16 x 1,5	M 20 x 1,5	A	9	8	13	25	1.239.1620.50
M 20 x 1,5	M 25 x 1,5	A	14	8	15	30	1.239.2025.50
M 25 x 1,5	M 32 x 1,5	C	16,5	15	15		1.239.2532.50
M 32 x 1,5	M 40 x 1,5	C	23	15	19,5		1.239.3240.50
M 40 x 1,5	M 50 x 1,5	C	30	15	19,5		1.239.4050.50
M 50 x 1,5	M 63 x 1,5	C	39	15	20		1.239.5063.50
M 12 x 1,5	PG 7	A	6,5	8	12	17	1.239.1207.50
M 16 x 1,5	PG 9	C	8,5	1	19		1.239.1609.50
M 20 x 1,5	PG 13,5	A	14	8	13	25	1.239.2013.50
M 63 x 1,5	PG 48	C	51	15	20		1.239.6348.50
PG 7	M 12 x 1,5	C	6	15	19		1.239.0712.11
PG 9	M 16 x 1,5	A	9	8	12	21	1.239.0916.11
PG 11	M 20 x 1,5	C	11,5	15	19		1.239.1120.11
PG 13,5	M 20 x 1,5	A	14	8	13	25	1.239.1320.11
PG 16	M 25 x 1,5	A	16	8	15	30	1.239.1625.11
PG 21	M 32 x 1,5	A	21	8	15	37	1.239.2132.11
PG 29	M 40 x 1,5	A	30	10	17	45	1.239.2940.11
PG 36	M 50 x 1,5	C	37	15	19,5		1.239.3650.11
PG 42	M 50 x 1,5	C	43	15	19,5		1.239.4250.11
PG 48	M 63 x 1,5	C	48	15	20		1.239.4863.11
PG 11	PG 13,5	B	12,5	8	15	24	1.233.1113.11
PG 13,5	PG 16	B	15	9	16	27	1.233.1316.11
PG 16	PG 21	B	16	10	19	32	1.233.1621.11
PG 21	PG 29	B	22,5	11	21	42	1.233.2129.11



Material	Polyamide VO according to UL 94
Operating Temperature	-40 °C – +100 °C (-40 °F – +212 °F)
Colours	grey (RAL 7035), black (RAL 9005)



// Other colours upon request

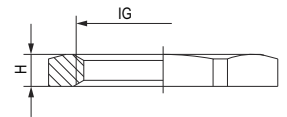

IG	H mm	 mm	Number PA VO grey	Number PA VO black
M 12 x 1,5	5	17	1.262.1200.50	1.262.1201.50
M 16 x 1,5	5	22	1.262.1600.50	1.262.1601.50
M 20 x 1,5	6	27	1.262.2000.50	1.262.2001.50
M 25 x 1,5	6,5	32	1.262.2500.50	1.262.2501.50
M 32 x 1,5	7	41	1.262.3200.50	1.262.3201.50
M 40 x 1,5	7	50	1.262.4000.50	1.262.4001.50
M 50 x 1,5	8	60	1.262.5000.50	1.262.5001.50
M 63 x 1,5	8	75	1.262.6300.50	1.262.6301.50
PG 7	5	19	1.262.0700.11	1.262.0701.11
PG 9	5	22	1.262.0900.11	1.262.0901.11
PG 11	5	24	1.262.1100.11	1.262.1101.11
PG 13,5	6	27	1.262.1300.11	1.262.1301.11
PG 16	6	30	1.262.1600.11	1.262.1601.11
PG 21	7	36	1.262.2100.11	1.262.2101.11
PG 29	7	46	1.262.2900.11	1.262.2901.11
PG 36	8	60	1.262.3600.11	1.262.3601.11
PG 42	8	65	1.262.4200.11	1.262.4201.11
PG 48	8	70	1.262.4800.11	1.262.4801.11
NPT 3/8"	7	24	1.262.3800.70	1.262.3801.70
NPT 1/2"	6	27	1.262.1200.70	1.262.1201.70
NPT 3/4"	7	32	1.262.3400.70	1.262.3401.70
NPT 1"	7	40	1.262.1000.70	1.262.1001.70

Metal-Fitting Clip



Material

Metal

RoHS

Size DN	fits to Metal-Conduit, Metal-Conduit A, B / Pro A / Pro B, C DN	Number
7	07 / - / -	1.574.0760.00
9	09 / - / -	1.574.0960.00
11	11 / - / -	1.574.1160.00
14	11 / - / -	1.574.1460.00
16	16 / 16 / 16	1.574.1660.00
21	21 / 21 / 21	1.574.2160.00
26 / 27	- / 27 / 26	1.574.2660.00
35	35 / 35 / 35	1.574.3560.00
51	51 / - / -	1.574.5160.00

Polyamide-Conduit

Polyamide-Fitting

Metal-Conduit / Metal-Fitting

Metal-Conduit Pro / Metal-Fitting Pro

Accessories Polyamide / Metal

Locknut GM-Ms

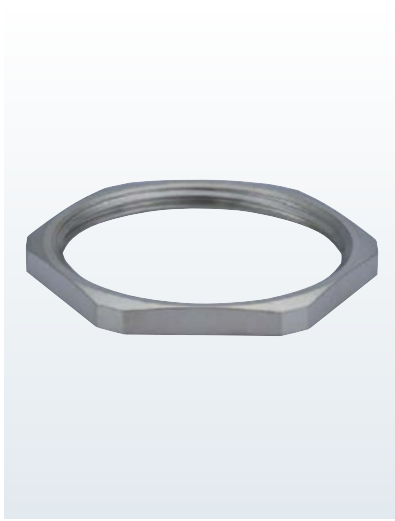

Material

Nickel plated brass

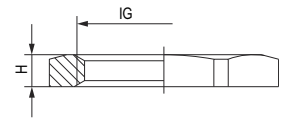

IG	H mm	mm	Number
M 12 x 1,5	2,8	15	1.161.1200.50
M 16 x 1,5	2,8	19	1.161.1600.50
M 20 x 1,5	3,0	23	1.161.2000.50
M 25 x 1,5	3,5	29	1.161.2500.50
M 32 x 1,5	4,0	36	1.161.3200.50
M 40 x 1,5	4,5	45	1.161.4000.50
M 50 x 1,5	5,5	55	1.161.5000.50
M 63 x 1,5	6,0	70	1.161.6300.50
PG 7	2,8	15	1.161.0700.01
PG 9	2,8	18	1.161.0900.01
PG 11	3,0	21	1.161.1100.01
PG 13,5	3,0	23	1.161.1300.01
PG16	3,0	26	1.161.1600.01
PG 21	3,5	32	1.161.2100.01
PG 29	4,0	41	1.161.2900.01
PG 36	5,0	51	1.161.3600.01
PG 42	5,0	60	1.161.4200.01
PG 48	5,5	64	1.161.4800.01

Adapter R-H

Metr., PG

Material

Nickel plated brass

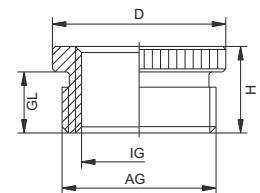

AG	IG	GL mm	H mm	D mm	Number
M 16 x 1,5	M 12 x 1,5	6,0	8,5	18	1.076.1612.50
M 20 x 1,5	M 12 x 1,5	6,5	9,0	24	1.076.2012.50
M 20 x 1,5	M 16 x 1,5	6,5	9,0	24	1.076.2016.50
M 25 x 1,5	M 16 x 1,5	7,0	10,0	30	1.076.2516.50
M 25 x 1,5	M 20 x 1,5	7,0	10,0	30	1.076.2520.50
M 32 x 1,5	M 20 x 1,5	8,0	11,5	39	1.076.3220.50
M 32 x 1,5	M 25 x 1,5	8,0	11,5	39	1.076.3225.50
M 40 x 1,5	M 25 x 1,5	8,0	11,5	43	1.076.4025.50
M 40 x 1,5	M 32 x 1,5	9,0	12,5	43	1.076.4032.50
M 50 x 1,5	M 32 x 1,5	10,0	14,0	57	1.076.5032.50
M 50 x 1,5	M 40 x 1,5	10,0	14,0	57	1.076.5040.50
M 63 x 1,5	M 40 x 1,5	10,0	14,0	64	1.076.6340.50
M 63 x 1,5	M 50 x 1,5	10,0	14,0	64	1.076.6350.50
PG 9	PG 7	6	8,5	17	1.071.0907.01
PG 11	PG 7	6	8,5	20	1.071.1107.01
PG 11	PG 9	6	8,5	20	1.071.1109.01
PG 13,5	PG 9	6,5	9	22	1.071.1309.01
PG 13,5	PG 11	6,5	9	22	1.071.1311.01
PG 16	PG 9	6,5	9,5	24	1.071.1609.01
PG 16	PG 11	6,5	9,5	24	1.071.1611.01
PG 16	PG 13,5	6,5	9,5	24	1.071.1613.01
PG 21	PG 11	7	10	30	1.071.2111.01
PG 21	PG 13,5	7	10	30	1.071.2113.01
PG 21	PG 16	7	10	30	1.071.2116.01
PG 29	PG 16	8	11,5	39	1.071.2916.01
PG 29	PG 21	8	11,5	39	1.071.2921.01
PG 36	PG 21	9	12,5	50	1.071.3621.01
PG 36	PG 29	9	12,5	50	1.071.3629.01
PG 42	PG 29	10	14	57	1.071.4229.01
PG 42	PG 36	10	14	57	1.071.4236.01
PG 48	PG 36	10	14	64	1.071.4836.01

Adapter RSD-Ms Metr.



Material	Nickel plated brass
O-Ring	Buna-N
Operating Temperature	-40 °C – 100 °C (-40 °F – 212 °F)



// Other O-Ring materials upon request

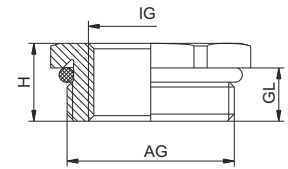

AG	IG	GL mm	H mm	mm	Number
M 16 x 1,5	M 12 x 1,5	5	8	17	1.077.1612.50
M 20 x 1,5	M 12 x 1,5	6	9	22	1.077.2012.50
M 20 x 1,5	M 16 x 1,5	6	9	22	1.077.2016.50
M 25 x 1,5	M 16 x 1,5	7	10	29	1.077.2516.50
M 25 x 1,5	M 20 x 1,5	7	10	29	1.077.2520.50
M 32 x 1,5	M 16 x 1,5	8	11	34	1.077.3216.50
M 32 x 1,5	M 20 x 1,5	8	11	34	1.077.3220.50
M 32 x 1,5	M 25 x 1,5	8	11	34	1.077.3225.50
M 40 x 1,5	M 20 x 1,5	8	12	43	1.077.4020.50
M 40 x 1,5	M 25 x 1,5	8	12	43	1.077.4025.50
M 40 x 1,5	M 32 x 1,5	8	12	43	1.077.4032.50
M 50 x 1,5	M 25 x 1,5	9	13	55	1.077.5025.50
M 50 x 1,5	M 32 x 1,5	9	13	55	1.077.5032.50
M 50 x 1,5	M 40 x 1,5	9	13	55	1.077.5040.50
M 63 x 1,5	M 32 x 1,5	10	14	65	1.077.6332.50
M 63 x 1,5	M 40 x 1,5	10	14	65	1.077.6340.50
M 63 x 1,5	M 50 x 1,5	10	14	65	1.077.6350.50

Adapter RSD-Ms

PG



Material	Nickel plated brass
O-Ring	Buna-N
Operating Temperature	-40 °C – 100 °C (-40 °F – 212 °F)

// Other O-Ring materials upon request

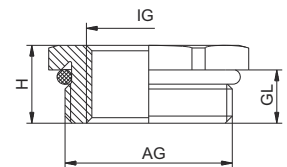

AG	IG	GL mm	H mm	 mm	Number
PG 9	PG 7	6	8,8	17	1.077.0907.01
PG 11	PG 7	6	9	20	1.077.1107.01
PG 11	PG 9	6	9	20	1.077.1109.01
PG 13,5	PG 9	6,5	9,5	22	1.077.1309.01
PG 13,5	PG 11	6,5	9,5	22	1.077.1311.01
PG 16	PG 9	6,5	9,5	24	1.077.1609.01
PG 16	PG 11	6,5	9,5	24	1.077.1611.01
PG 16	PG 13,5	6,5	9,5	24	1.077.1613.01
PG 21	PG 11	7	10,3	30	1.077.2111.01
PG 21	PG 13,5	7	10,3	30	1.077.2113.01
PG 21	PG 16	7	10,3	30	1.077.2116.01
PG 29	PG 16	8	11,5	40	1.077.2916.01
PG 29	PG 21	8	11,5	40	1.077.2921.01
PG 36	PG 21	9	12,5	50	1.077.3621.01
PG 36	PG 29	9	12,5	50	1.077.3629.01
PG 42	PG 29	10	13,5	57	1.077.4229.01
PG 42	PG 36	10	13,5	57	1.077.4236.01
PG 48	PG 36	10	13,5	64	1.077.4836.01
PG 48	PG 42	10	13,5	64	1.077.4842.01

Polyamide-Conduit

Polyamide-Fitting

Metal-Conduit / Metal-Fitting

Metal-Conduit Pro / Metal-Fitting Pro

Accessories Polyamide / Metal

Numerical / Alphabetical index

Product Number	Description	Page	Product Number	Description	Page	Product Number	Description	Page
1.071	Adapter R-H	31	1.527	Polyamide-Conduit Slit	5	1.548	Polyamide-Fitting DUO-Ms PG	12
1.076	Adapter R-H	31	1.533	Polyamide-Fitting	6	1.560	Metal-Conduit A	16
1.077	Adapter RSD-Ms	32-33	1.534	Polyamide-Fitting Clip	25	1.561	Metal-Conduit B	17
1.161	Locknut GM-Ms	30	1.535	Polyamide-Fitting 90	7	1.562	Metal-Conduit Pro A	20
1.239	Adapter E-M-PA, K-FS	27	1.536	Polyamide-Fitting T	8	1.563	Metal-Conduit Pro B	21
1.262	Locknut GM-FS	28	1.537	Polyamide-Fitting Y	9	1.564	Metal-Conduit Pro C	22
1.273	Adapter R-M-PA	26	1.542	Polyamide-Fitting DUO-PA metr.	14	1.574	Metal-Fitting Clip	29
1.503	Polyamide Cut	5	1.542	Polyamide-Fitting DUO-PA NPT	15	1.570	Metal-Fitting	18
1.510	Polyamide-Conduit	4	1.543	Polyamide-Fitting DUO-PA PG	14	1.571	Metal-Fitting S	19
1.511	Polyamide-Fitting N	10	1.547	Polyamide-Fitting DUO-Ms metr.	12	1.572	Metal-Fitting Pro	23
1.513	Polyamide-Fitting W	11	1.547	Polyamide-Fitting DUO-Ms NPT	13	1.573	Metal-Fitting Pro S	24

Limited Liability

Products, design, colours and dimensions are subject to change without prior notice. We reserve the right to make technical improvements on all our products, currently ordered or for future orders. It is the user's responsibility to verify all dimensions and technical data. HUMMEL AG will assume no liability regarding information provided to the user by published literature or inside technical staff, its distributors and outside sales personnel. Errors in the catalogue can occur and shall not create any liability whatsoever for HUMMEL. All information provided by HUMMEL is without guarantee and must be verified by the user.

Created & Printed by

Graphic & Layout:

HUMMEL AG, Marketing & Communications, Lise-Meitner-Str. 2, 79211 Denzlingen, Germany, Tel. +49 (0) 76 66 9 11 10-0, Fax +49 (0) 76 66 9 11 10-20, info@hummel.com

Printer:

Druckerei Furtwängler GmbH, 79211 Denzlingen, Germany, Tel. +49 (0) 76 66 / 13 31. Printed on recycled paper in November 2019.

Europe

HUMMEL France

HUMMEL CONNECTEURS SAS
ZI – Rue de l'Acqueline
51800 Sainte Ménéhould / France

Tel. +33 (0) 3 89 / 55 37 20
Fax +33 (0) 3 89 / 53 80 27
E-Mail info.fr@hummel.com
www.hummel.com

HUMMEL UK

HUMMEL UK Limited
Office 3, Momentum House
Enterprise Way, Lowton St Marys,
Warrington, Cheshire, WA3 2BP
United Kingdom

Tel. +44 (0) 19 42 / 60 56 95
Fax +44 (0) 19 42 / 26 93 24
E-Mail info.uk@hummel.com
www.hummel.com

HUMMEL Italy

HUMMEL S.r.l.
Via Enrico Fermi 61
10091 Alpignano (Torino) / Italy

Tel. +39 (0) 11 / 9 68 26 38
Fax +39 (0) 11 / 9 78 55 50
E-Mail info.it@hummel.com
www.hummel.com

HUMMEL Poland

HUMMEL Sales Office Poland
Al. 23 Stycznia 26 lok. 20
86-300 Grudziadz / Poland

Tel. +48 (0) 6 62 / 38 27 99
Fax +48 (0) 56 / 6 43 00 11
E-Mail info.pl@hummel.com
www.hummel.com

HUMMEL Russia

OOO HUMMEL
Ul. Retschnikov 21, Strojenije 1
115142 Moskau / Russia

Tel. +7 (0) 4 99 / 7 82 40 68
Fax +7 (0) 4 99 / 6 14 67 40
E-Mail info.ru@hummel.com
www.hummel-russia.ru

HUMMEL Scandinavia

HUMMEL Connector Systems AB

Tel. +46 (0) 73 / 8 00 12 00
E-Mail info.se@hummel.com
www.hummel.com

Asia

HUMMEL China

HUMMEL Connector Systems (Shanghai) Co., Ltd.
Room 1701 Central Plaza
No.227 Huang Pi (N) Road
200003 Shanghai / P.R. China

Tel. +86 (0) 21 / 63 75 85 51
Fax +86 (0) 21 / 63 75 85 53
E-Mail info.hcs.cn@hummel.com
www.hummel.com

HUMMEL India

HUMMEL Connector Systems Price Limited
307, Surya Kiran Building
19 Kasturba Gandhi Marg
New Delhi – 110001 / India

Tel. +91 (0) 11 / 43 00 75-21 / -23
Fax +91 (0) 11 / 43 00 75-22
E-Mail info.in@hummel.com
www.hummel.com

HUMMEL South Korea

HUMMEL AG KOREA Co., Ltd.
#628 Ssangyong Platinum River
659, Olympic-ro, Gangdong-gu
Seoul, 05248 / Korea

Tel. +82 (0) 2 / 4 70 27 62
Fax +82 (0) 2 / 4 70 27 63
E-Mail info.kr@hummel.com
www.hummel.com

South America

HUMMEL Brazil

HUMMEL Connector Systems Ltda.
Rua Derville Gabriel Pereira, 280
Barro Preto – Centro Empresarial Tatui I
CEP 18280-614 – Tatui / SP / Brazil

Tel. +55 (0) 15 / 33 22 70 00
Fax +55 (0) 15 / 33 22 70 26
E-Mail vendas@hummel.com.br
www.hummel.com.br

ELECTRIC COMPONENTS

Cable Glands

Polyamide-, Brass- and Stainless steel,
EMC-connections, Protection Ex e, Ex d, Ex ta



Circular Connectors

M 8 to M 40, INOX, TWILOCK, Industrial Ethernet,
Power, Signal, Hybrid-Connector, Moulded Cordsets



Cable Protection Systems

Corrugated Conduit Systems, Conduit Cable Glands,
Angled Systems, Combined Cable Glands, Accessories



Cable Assembly

Moulded Signal- and Power Circular Connectors,
Servo Cables, Cable Sets



www.hummel.com



HUMMEL AG
Lise-Meitner-Straße 2
79211 Denzlingen
Germany
www.hummel.com

Tel. +49 (0) 76 66 / 9 11 10-0
Fax +49 (0) 76 66 / 9 11 10-20
E-Mail info@hummel.com

